

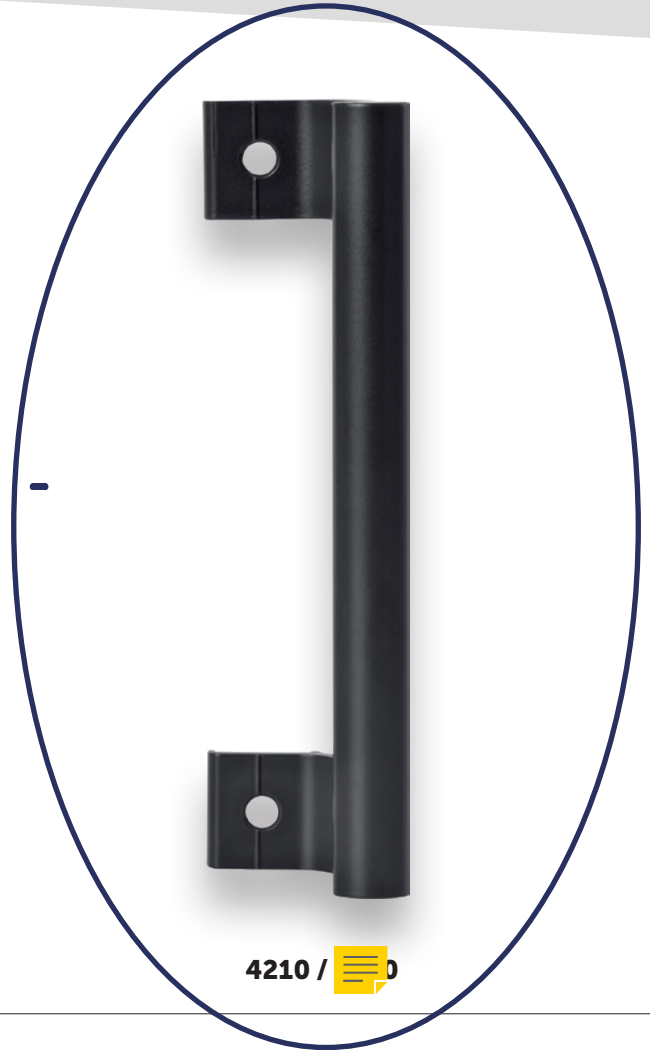

4350



UNHEIRO 4309



4210 / 

**EMBALAGEM - PACKAGING
EMPAQUETADO - EMBALLAGE**

50 unidades por caixa
50 pieces per box
50 unidades por caja
50 pieces par boîte

**MATERIAIS - MATERIALS
MATERIALES - MATERIAUX**

Alumínio - Zamak - Inox
Alluminium - Zamak - Stainless Steel
Aluminio - Zamak - Acero Inox
Alluminium - Zamak - Inox

**FIXAÇÃO - FIXING
FIJACIÓN - FIXATION**

Parafusos incluídos
Screws included
Tornillos incluidos
Vis inclus

**ACABAMENTO - FINISHING
ACABADOS - FINITION**

Lacado
Powder painting
Lacado
Laqué

**NORMA - STANDARD
NORMA - NORME**

EN 1670
EN 13126-19

**OBSERVAÇÕES - COMENTS
OBSERVACIONES - OBSERVATIONS**

4210 / 4310 / 4350
24 unidades por caixa
24 pieces per box
24 unidades por caja
24 pieces par boîte

FECHO LATERAL DE EMBUTIR · LATERAL INSERT BARREL · CIERRE DE EMBUTIR · VERROU COULISSE

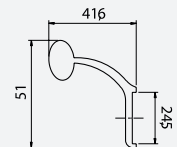
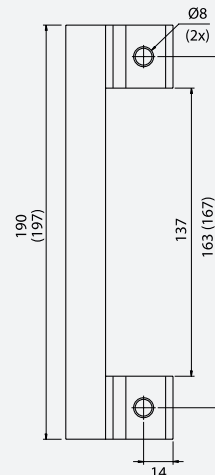
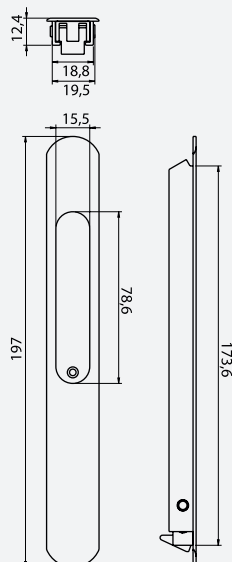
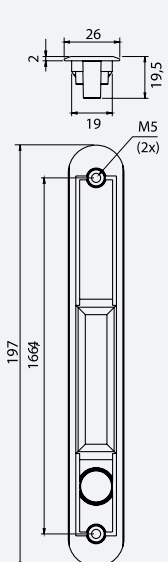

4310: 167mm
4210: 163mm

4310 → 4308
4210 → 2150 / 2170