



2172



2170 / 2171

FECHO LATERAL DE EMBUTIR
LATERAL INSERT BARREL
CIERRE DE EMBUTIR
VERROU COULISSE

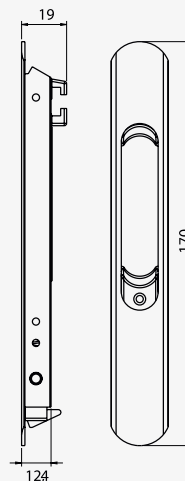
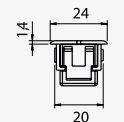

2172

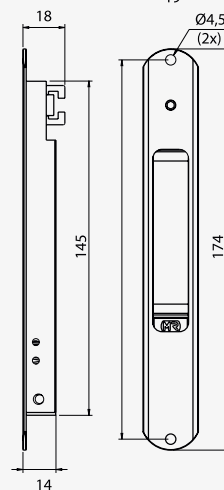
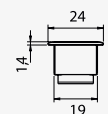

2170 / 2171

EMBALAGEM - PACKAGING
EMPAQUETADO - EMBALLAGE

50 unidades por caixa
50 pieces per box
50 unidades por caja
50 pieces par boîte

MATERIAIS - MATERIALS
MATERIALES - MATERIAUX

Alumínio - Zamak - Inox
Alluminium - Zamak - Stainless Steel
Aluminio - Zamak - Acero Inox
Alluminium - Zamak - Inox

FIXAÇÃO - FIXING
FIJACIÓN - FIXATION

Parafusos incluídos
Screws included
Tornillos incluidos
Vis inclus

ACABAMENTO - FINISHING
ACABADOS - FINITION

Lacado
Powder painting
Lacado
Laqué

NORMA - STANDARD
NORMA - NORME

EN 1670
EN 13126-19

OBSERVAÇÕES - COMENTS
OBSERVACIONES - OBSERVATIONS

2170 - c/ mola
2171 - s/ mola (manual)

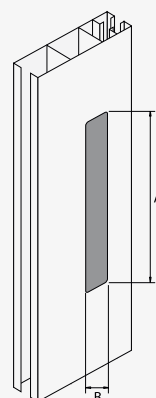

REF.	(A)	(B)
2170	146	19,5
2172	149	20
2150	146	19,5